

Mobile APP “Smart Life” Installation & Usage Guide

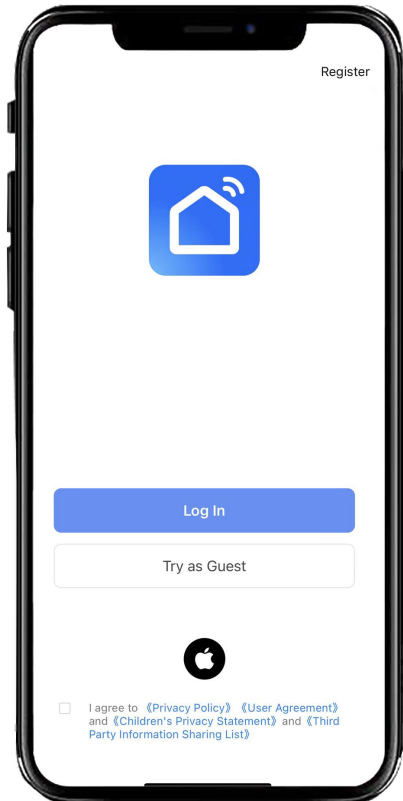

Smart Life App
Installation



Your solar fan is made Remote Controllable on mobile App “Smart Life”. Please scan the above QR code to download “Smart Life” and follow the below guidelines to add your solar fan into “Smart Life”, then you can one stop remote control your fan from anywhere at anytime in anyway.

1. Connect Your Solar Fan with Your Cellphone

1.1 power on your solar fan

1.2 turn on Bluetooth on your cellphone, and ensure a 2.4GHz WiFi network (not 5GHz WiFi) or a third-party Mobile Hotspot is available to use

1.3 open the “Smart Life” App, and finish its Log-In process until your solar fan device shows on the screen

1.4 click “Add”, and continue by entering WiFi information, until your solar fan is added successfully

1.5 click “Done”, then you can enter the “Smart Life” Control Interface

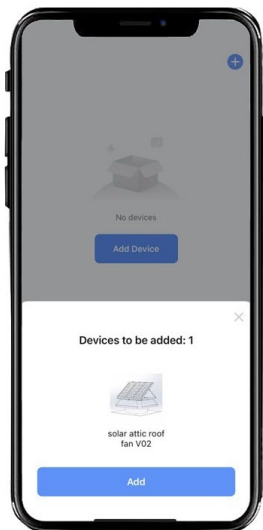

img. for 1.3

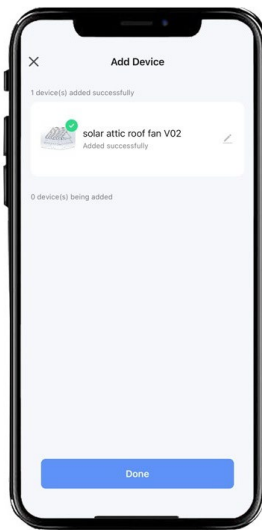

img. for 1.4

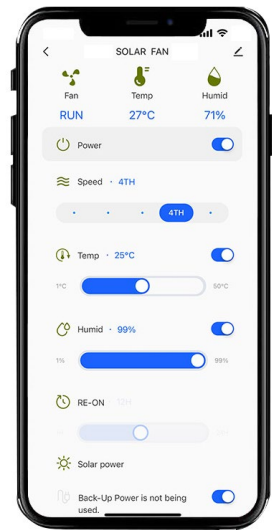

img. for 1.5

WARM TIPS: WiFi will be used as the primary communication mode between solar fan and your cellphone. If your solar fan is installed in a place without WiFi, please keep your mobile Bluetooth ON when you want to control the fan.

2. APP Cellphone Controlling Your Solar Fan



This 4-in-1 smart remote control APP system covers multiple functions of Temperature control, Humidity control, Speed adjustment and Time setting for your solar fan.

Factory Settings are:

25°C(77°F) at temperature control,
99%RH at humidity control,
4SPD at speed setting,
12H at time setting.

You can adjust any setting as needed.



Smart Life Usage Guide

- **Temperature and/or Humidity Control:**

adjustable Temperature Setting: 1°C~50°C (1°F ~122°F)

adjustable Humidity Setting: 1%RH~99%RH

Detection Values v.s. Setting Values	Fan Run/Stop Performance
temperature detection > setting	Fan RUN
humidity detection > setting	Fan RUN
temperature detection < setting, & humidity detection < setting	Fan STOP
if temperature control is set Disabled & humidity control is set Enabled	Fan runs / stops only under humidity control
if humidity control is set Disabled & temperature control is set Enabled	Fan runs / stops only under temperature control
if both temperature control & humidity control are set disabled	Fan is free to run without any weather control

- **Speed Control:** 1SPD, 2SPD, 3SPD, 4SPD, AUTO

- **Re-On Time Setting:** 1H ~ 24H

Your fan will enter a countdown after turned off. When the set Re-On time is up, it will immediately restart running if the ambient Temperature / Humidity condition meets the setting values; otherwise, the fan will remain static.

- **Power Mode:** Purely Solar Powered or Hybrid Powered with A Backup Power Source

If your solar fan is hybrid powered, you can even flexibly Enable or Disable its backup power source.

- **One Solar Fan Can be Controlled by “Smart Life” from Several Cellphones:**

You can control the solar fan together with others by sharing its APP link:

1) click  on the right corner

2) click “Share Device”

3) share the App link with others through any available third-party platform