

illume™ Dimmer Kit Instructions

! WARNING
This product contains a button battery.
Hazardous if swallowed.

Thank you for your purchase. This manual describes how to pair the remote control to your illume.

CONTENTS

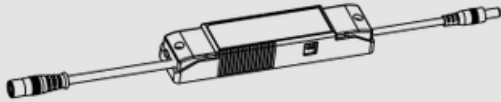

Dimming Control Module
Type A OR Type B

ENSURE YOU HAVE THE CORRECT DIMMER CONTROL MODULE BEFORE PROCEEDING (See table below)

*Please note this item will replace your current illume's control module. This is a receiver and control module in 1. The illume may flicker if the standard control module is used in conjunction.



Single Remote

OR



4 - Channel Remote



CR2032 Battery

! WARNING
KEEP OUT OF REACH OF CHILDREN
Swallowing can lead to chemical burns, perforation of soft tissue, and death. Severe burns can occur within 2 hours of ingestion. Seek medical attention immediately.



Changing your Battery

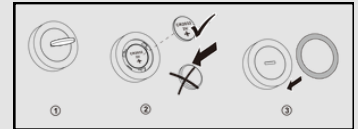
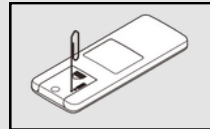

*Please ensure the cap is fasten tight after replacement for child safety.

DIMMER CONTROL MODULE SET

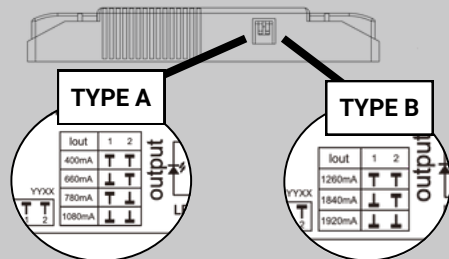

Type A Models

	mA Value	Switch Position
180mm, 300mm Retail	400mA	TT
270mm, 280mm Low Spec, 300mm, 400mm Retail	660mA	LT
280mm High Spec, 350mm Low Spec, 400mm, 300x600mm	780mA	TL
350mm High Spec, 400x600mm, 500mm	1080mA	LL

Type B Models

	mA Value	Switch Position
600mm	1260mA	TT
300x1200mm	1840mA	LT
700mm, 400x1200mm, 600x900mm	1920mA	LL

REMOTE FUNCTIONS



4 Channel Remote

Master on/off button
C1-C4 – Channel 1 to Channel 4 buttons – Press once to turn channel on and off, press and hold to dim – release to stop. Press and hold again to brighten – release to stop.



Single Channel Remote

Master on/off button – Press once to turn unit on and off, press and hold to dim – release to stop. Press and hold again to brighten – release to stop.

PAIRING

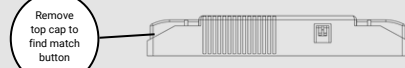

Place the Dimmable Control Module in place of the existing control module
***If existing control module is not removed, unit may flicker.**

1. This will be position right behind the illume light panel as per diagram below.
2. Once plugged on both input and output side, Short Press the Match button, located underneath the cap on the input side of the receiver.
3. The blue LED next to the Match button will begin to flash when the unit in pairing mode.
4. While the blue LED is flashing, short press the Power Button on the Single channel remote, or the desired channel button on the 4-channel remote.
5. The blue LED will turn off, and the illume itself will flash on and off 3 times to indicate it has paired.
6. Replace Cap over match button.

The illume will now be controllable by the remote.

DELETE LINK

1. Press and hold match key for 10 seconds.
2. The illume will flash 3 times to indicate the link has been deleted.

ORDER OF INSTALLATION

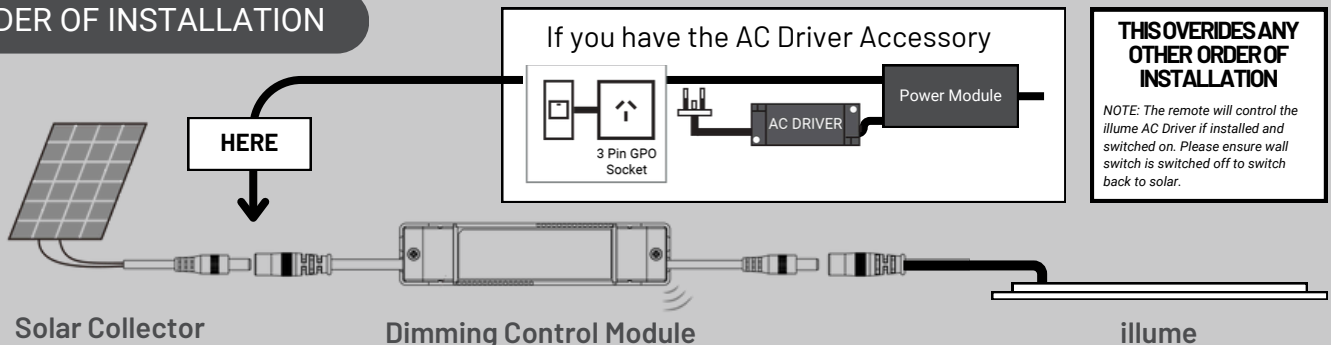

THIS OVERRIDES ANY OTHER ORDER OF INSTALLATION

NOTE: The remote will control the illume AC Driver if installed and switched on. Please ensure wall switch is switched off to switch back to solar.